

DOMOTECK  
DOMOTECK | DOMOTECK  
DOMOTECK  
DOMOTECK | DOMOTECK  
DOMOTECK

# Floor heating Products 2013

DOMOTECK  
DOMOTECK | DOMOTECK  
DOMOTECK  
DOMOTECK | DOMOTECK  
DOMOTECK

V 10.12.2012

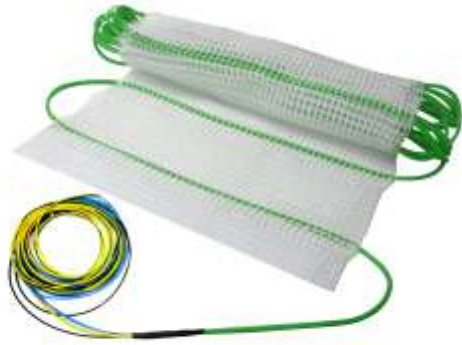

## MULTITHERM HEATING MAT

**Domotek's Multitherm Heating** is an efficient and energy saving system. It is constructed in such a way, that instead of two identical resistant wires the heating cable has two different resistant wires, one 7W/lm and the other 10W/lm. The **7W/lm** heating wires are operated and controlled by a central floor thermostat to give a basic temperature in the floor construction.

The **10W/lm** heating wires are controlled by individual room thermostats. If operated alone, they will give comfort temperature in-between seasons in selected areas, and if operated together with the **7W/lm**, will answer the heat demand in selected areas / rooms.

Central thermostat	Individual Thermostats	Output	Temperature
ON	OFF	7W/lm	Basic temp. for the whole house
OFF	ON	10W/lm	Basic temp. for selected areas
ON	ON	17W/lm	Basic temp in the deep of winter

### TECHNICAL DATA:

### FHM 2 B 3-960

Output Mat	$50W/m^2 - 70W/m^2 - (50+70)=120W/m^2$
Output Cable	$7W/lm - 10W/lm - (7+10)=17W/lm$
Voltage	~230V
First layer of cable	XLPE
Outer insulation	PVC
Thickness of mat/wire	~5.6mm
Type of net	Textile 10N
Protection class/means	I + 30mA RCD
Connection	One side connection
Cable color	Blue
Space between heating wire	14cm
Supply lead length	2.5m x 2 + Earthing wire



**CU 333** Central Thermostat

Set on **Floor** Mode



**CU 345** Individual Thermostat

Set on **Room** Mode

**Reference Mat Output :  $50W/m^2$**  To be installed in the reference area where the central thermostat sensor is installed.



All graphics & pictures are for illustration only

Floor Warming Products



Copyright 2006-2012 © All rights reserved. www.decoragroup.com www.domotek.com & all related companies. The materials in this page, may not be reproduced, photocopied, displayed, modified or distributed in any form whatsoever without the express prior written permission of the copyright holder.

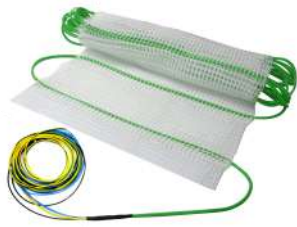

# MULTITHERM HEATING MAT

## Technical Applications

## Installation

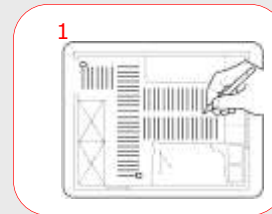
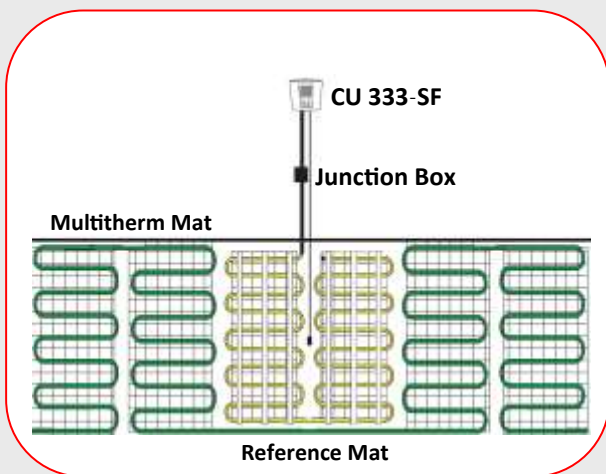
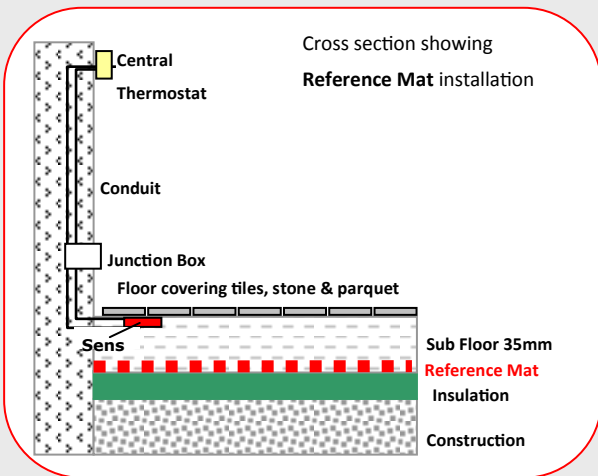
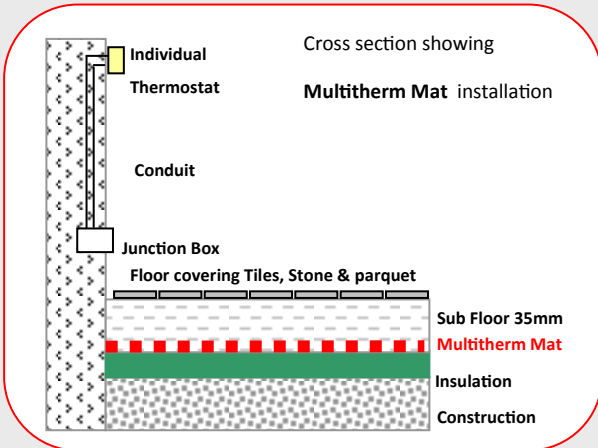

Plan the layout



Attach one of Domotek's testing instruments

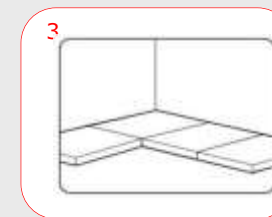

Place insulation boards

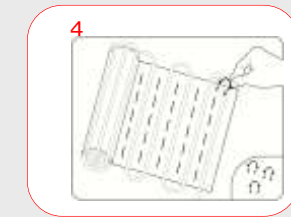

With plastic hooks fasten the reference mat onto the boards

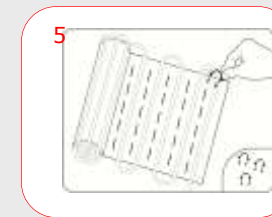

With plastic hooks fasten the Multitherm mat onto the boards

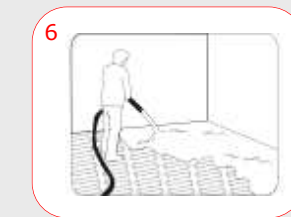

Pour over the self aligned concrete

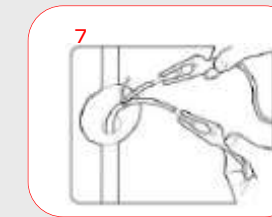

Test resistance

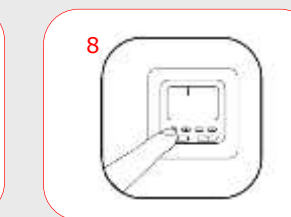

Connect the reference mat to the central thermostat, and the Multitherm to the individual thermostats

For full installation details please refer to product installation manual

**DOMOTECK'S WARRANTY POLICY** Domotek's products are guaranteed by a 10-year Limited Product Warranty, and are designed to safely operate in accordance to the life-span of the application in which they are installed.

All graphics & pictures are for illustration only

FLOOR WARMING PRODUCTS



Copyright 2006-2012 © All rights reserved. www.decoragroup.com www.domotek.com & all related companies. The materials in this page, may not be reproduced, photocopied, displayed, modified or distributed in any form whatsoever without the express prior written permission of the copyright holder.



## UNIVERSAL THERMOSOL FE MAT

- **Ideal for in-slab installation**

### TECHNICAL DATA:

### FHM 2 B 3 –810 DOMOTECK

Output Mat	106W/m <sup>2</sup>
Output Cable	17W/m
Voltage	~230V
First layer	FEP
Outer Insulation	PVC
Thickness of wire	~5.6mm
Protection class/means	I + 30mA RCD
Connection	One side - Twin conductor
Cable Color	Blue
Space between cable	16cm
Supply Lead Length	2.5m

**RECOMMENDED FOR UNDER:** Tiles and Natural Stone although it can be installed under other floor coverings such as: Parquet, Laminate, Linoleum or carpets, in these cases the mat must be integrated into a 35mm layer of self-leveling concrete.

- Domoteck's Universal Mat is a heating system designed for in-slab installation suitable mainly for new construction.
- Can be installed in specific areas or throughout the entire house, for wet installation.
- Domoteck Universal Mats have a twin conductor (a one-point connection to the wiring system of the building).

All graphics & pictures are for illustration only

Floor Warming Products



Copyright 2006-2012 © All rights reserved. www.decoragroup.com www.domoteck.com & all related companies. The materials in this page, may not be reproduced, photocopied, displayed, modified or distributed in any form whatsoever without the express prior written permission of the copyright holder.





# UNIVERSAL THERMOSOL FE MAT

## Technical Applications & Installation

## Installation

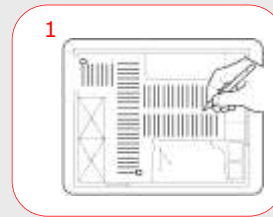
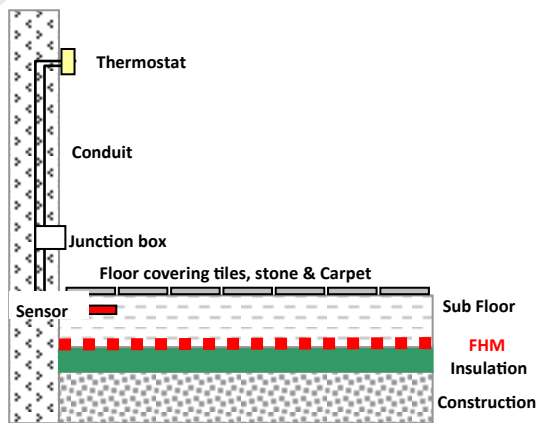
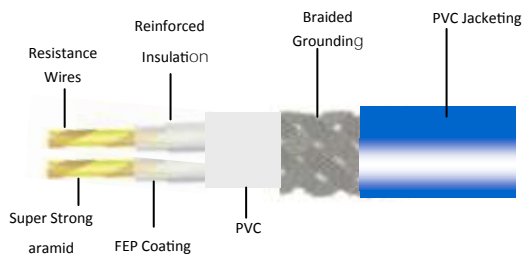

Plan the layout



Fault Indicator

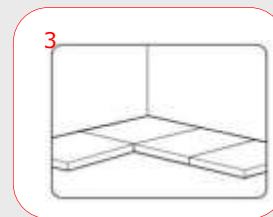

Place the insulation boards



Fix the mat on to the insulation boards



Pour over the mat a layer of self leveling concrete

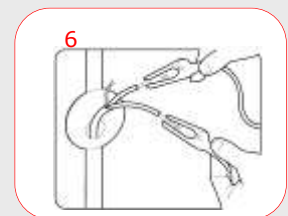

Test resistance

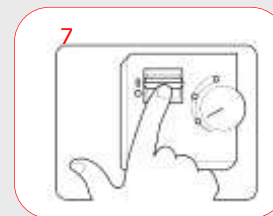

Set the thermostat

For full installation details please refer to product installation manual

### DOMOTECK'S WARRANTY POLICY

Domotek's products are guaranteed by a 10-year Limited Product Warranty, and are designed to safely operate in accordance to the life-span of the application in which they are installed.

All graphics & pictures are for illustration only

FLOOR WARMING PRODUCTS





## CLASSIC THERMOSOL FE CABLE

- Heating cable ideal for complicated layouts
- Optimal customization
- Domotek's Classic Thermosol FE Cable is a heating system designed for in-slab installation suitable mainly for new construction.

### TECHNICAL DATA:

FHC 2 B 3 –676 DOMOTECK

Output Cable	17W/m
Voltage	~230V
First Layer	FEP
Outer Insulation	PVC
Thickness of wire	~5.6mm
Protection class/means	I + 30mA RCD
Connection	One side - Twin conductor
Cable Color	Blue
Supply Lead Length	2.5m

**RECOMMENDED FOR UNDER:** Tiles and natural stone although it can be installed under other floor coverings such as: Parquet, Laminate, Linoleum or carpets, in these cases the mat must be integrated into a 35mm layer of self-leveling concrete.

- Can be installed in specific areas or throughout the entire house, for wet installation.
- Domotek Classic thermosol FE Cable has a twin conductor (a one-point connection to the wiring system of the building).
- Different anchoring means are available.

All graphics & pictures are for illustration only

Floor Warming Products



Copyright 2006-2012 © All rights reserved. www.decoragroup.com www.domotek.com & all related companies. The materials in this page, may not be reproduced, photocopied, displayed, modified or distributed in any form whatsoever without the express prior written permission of the copyright holder.



# CLASSIC THERMOSOL FE CABLE

## Technical Applications & Installation

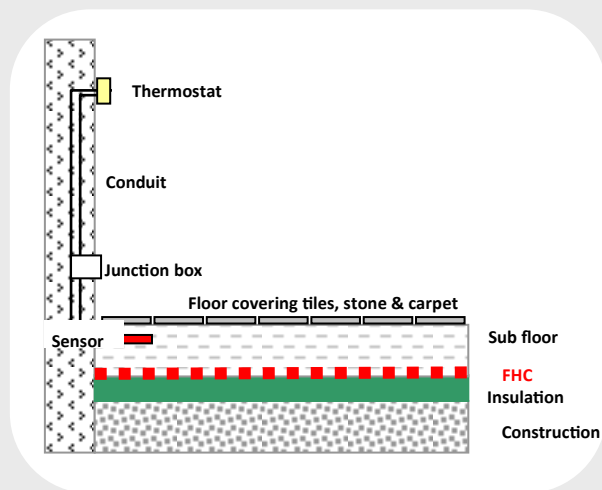
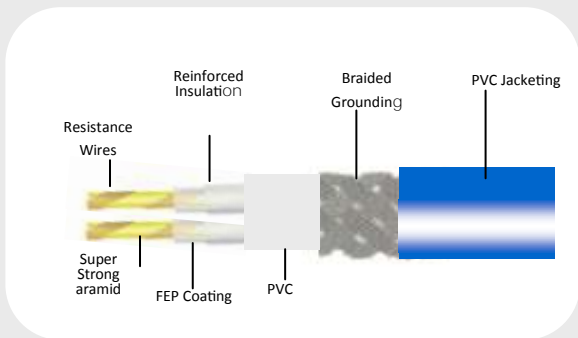

### DOMOTECK'S WARRANTY POLICY

Domotek's products are guaranteed by a 10-year Limited Product Warranty, and are designed to safely operate in accordance to the life-span of the application in which they are installed.

## Installation

- 1 Plan the layout
- 2 Fault Indicator
- 3 Place insulation boards
- 4 Fasten the spacers
- 5 Fix cable into the spacers
- 6 Pour the self leveling concrete
- 7 Test resistance
- 8 Set the thermostat

For full installation details please refer to product installation manual

All graphics & pictures are for illustration only

FLOOR WARMING PRODUCTS





## UNIVERSAL THERMOSOL XL MAT

- **Ideal for in-slab installation**

### TECHNICAL DATA:

FHM 2 B 4 –809 DOMOTECK

Output Mat	106W/m <sup>2</sup>
Output Cable	17W/m
Voltage	~230V
First layer	XLPE
Outer Insulation	PVC
Thickness of wire	~6.2mm
Protection class/means	I + 30mA RCD
Connection	One side - Twin conductor
Cable Color	Blue
Space between cable	16cm
Supply Lead Length	2.5m

**RECOMMENDED FOR UNDER:** Tiles and natural stone although it can be installed under other floor coverings such as: parquet, laminate, linoleum or carpets, in these cases the mat must be integrated into a 35mm layer of self-leveling concrete.

- Domoteck's Universal Mat is a heating system designed for in-slab installation suitable mainly for new construction.
- Can be installed in specific areas or throughout the entire house, for wet installation.
- Domoteck Universal Mats have a twin conductor (a one-point connection to the wiring system of the building).

All graphics & pictures are for illustration only

Floor Warming Products



Copyright 2006-2012 © All rights reserved. www.decoragroup.com www.domoteck.com & all related companies. The materials in this page, may not be reproduced, photocopied, displayed, modified or distributed in any form whatsoever without the express prior written permission of the copyright holder.





# UNIVERSAL THERMOSOL XL MAT

## Technical Applications & Installation

## Installation

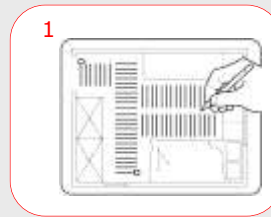
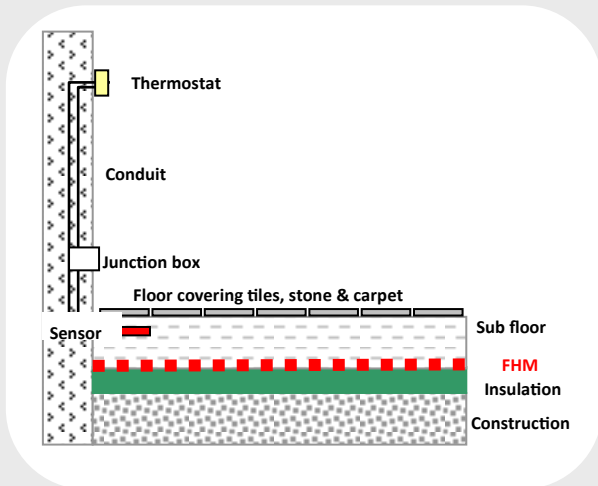
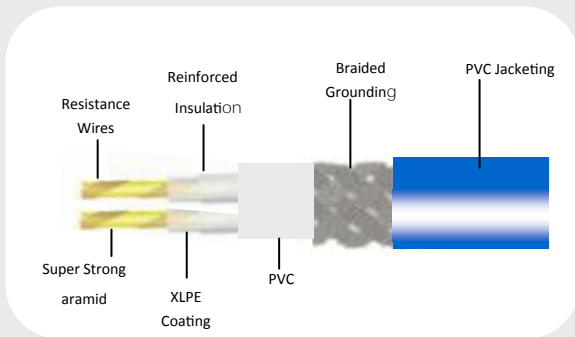

Plan the layout



Fault Indicator

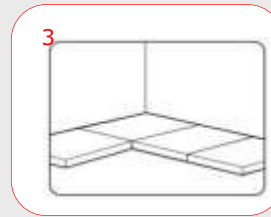

Place the insulation boards

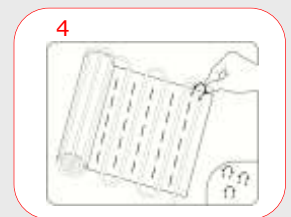

Fix the mat on to the insulation boards

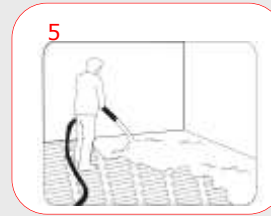

Pour over the mat a layer of self leveling concrete

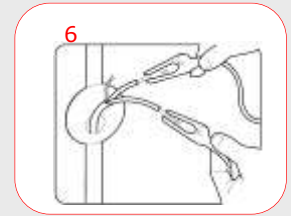

Test resistance

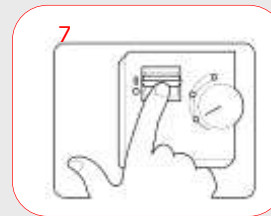

Set the thermostat

For full installation details please refer to product installation manual

### DOMOTECK'S WARRANTY POLICY

Domotek's products are guaranteed by a 10-year Limited Product Warranty, and are designed to safely operate in accordance to the life-span of the application in which they are installed.

All graphics & pictures are for illustration only

FLOOR WARMING PRODUCTS





## CLASSIC THERMOSOL XL CABLE

- Heating cable ideal for complicated layouts
- Optimal customization
- Domotek's Classic Thermosol XL Cable is a heating system designed for in-slab installation suitable mainly for new construction.

### TECHNICAL DATA:

FHC 2 B 4 –634 DOMOTECK

Output Cable	17W/m
Voltage	~230V
First Layer	XLPE
Outer Insulation	PVC
Thickness of wire	~6.2mm
Protection class/means	I + 30mA RCD
Connection	One side - Twin conductor
Cable Color	Blue
Supply Lead Length	2.5m

**RECOMMENDED FOR UNDER:** Tiles and natural stone although it can be installed under other floor coverings such as: parquet, laminate, linoleum or carpets, in these cases the mat must be integrated into a 35mm layer of self-leveling concrete.

- Can be installed in specific areas or throughout the entire house, for wet installation.
- Domotek Classic thermosol XL Cable has a twin conductor (a one-point connection to the wiring system of the building).
- Different anchoring means are available.

All graphics & pictures are for illustration only

Floor Warming Products



Copyright 2006-2012 © All rights reserved. www.decoragroup.com www.domotek.com & all related companies. The materials in this page, may not be reproduced, photocopied, displayed, modified or distributed in any form whatsoever without the express prior written permission of the copyright holder.







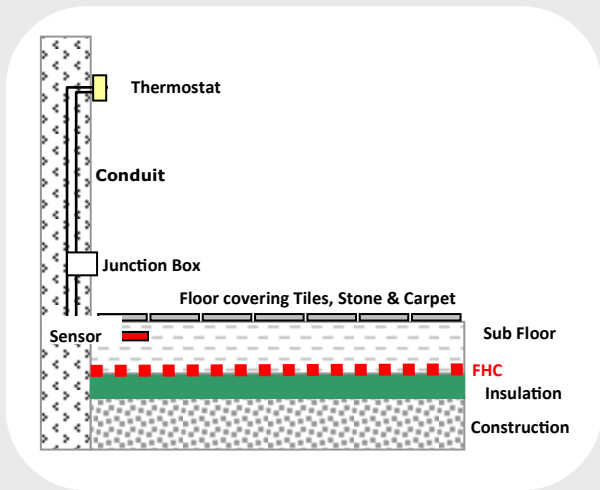
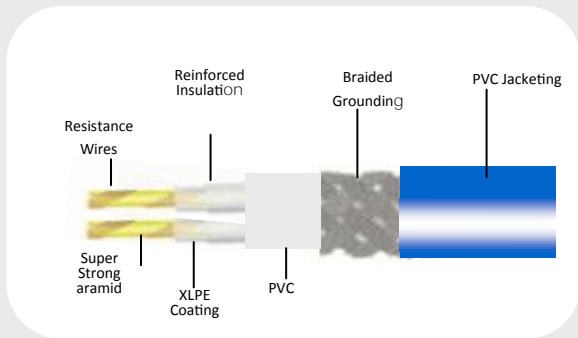

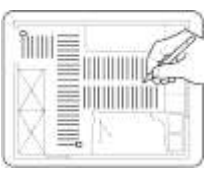

# CLASSIC THERMOSOL XL CABLE

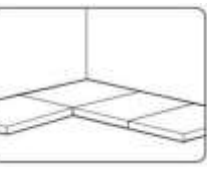
## Technical Applications & Installation

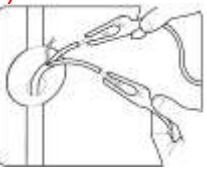

## Installation

- 1  Plan the layout
- 2  Fault Indicator
- 3  Place insulation boards
- 4  Fasten the spacers
- 5  Fix cable into the spacers
- 6  Pour the self leveling concrete
- 7  Test resistance
- 8  Set the thermostat

### DOMOTECK'S WARRANTY POLICY

Domotek's products are guaranteed by a 10-year Limited Product Warranty, and are designed to safely operate in accordance to the life-span of the application in which they are installed.

For full installation details please refer to product installation manual

All graphics & pictures are for illustration only

FLOOR WARMING PRODUCTS





## BASIC FH MAT

- **Ideal for in-slab installation**

### TECHNICAL DATA:

FHM 2 B 4 -763 DOMOTECK

Output Mat	170W/m <sup>2</sup>
Output Cable	17W/m
Voltage	~230V
First layer	XLPE
Outer Insulation	XLPE
Thickness of wire	~6.0mm
Protection class/means	I + 30mA RCD
Connection	One side - Twin conductor
Base material	Textile strips
Cable Color	Black
Space between cable	10cm
Supply Lead Length	4m

**RECOMMENDED FOR UNDER:** Tiles and natural stone although it can be installed under other floor coverings such as: parquet, laminate, linoleum or carpets, in these cases the mat must be integrated into a 35mm layer of self-leveling concrete.

- **Domoteck's Basic FH Mat** is a heating system designed for in-slab installation suitable mainly for new construction.
- Can be installed in specific areas or throughout the entire house, for wet installation.
- **Domoteck Basic FH Mats** have a twin conductor (a one-point connection to the wiring system of the building).

All graphics & pictures are for illustration only

Floor Warming Products



Copyright 2006-2012 © All rights reserved. www.decoragroup.com www.domoteck.com & all related companies. The materials in this page, may not be reproduced, photocopied, displayed, modified or distributed in any form whatsoever without the express prior written permission of the copyright holder.



# BASIC FH MAT

## Technical Applications & Installation

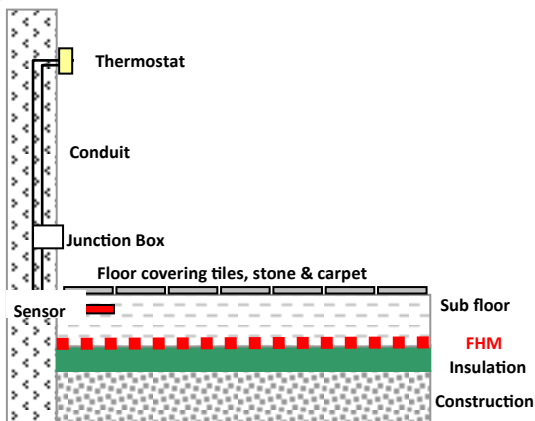
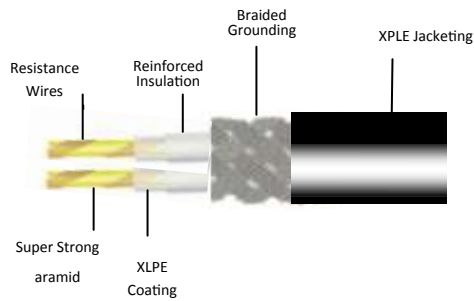

### DOMOTECK'S WARRANTY POLICY

Domotek's products are guaranteed by a 10-year Limited Product Warranty, and are designed to safely operate in accordance to the life-span of the application in which they are installed.

## Installation

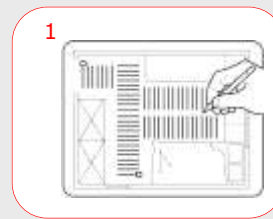

Plan the layout



Fault Indicator

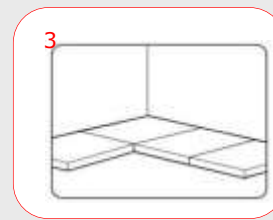

Place the insulation boards



Fix the mat on to the insulation boards

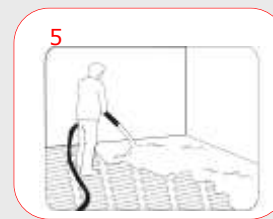

Pour over the mat a layer of self leveling concrete

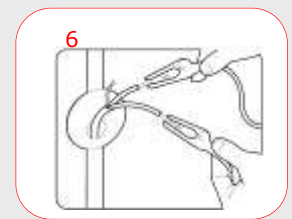

Test resistance

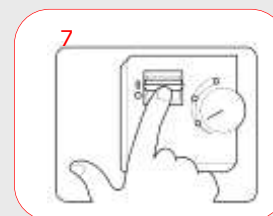

Set the thermostat

For full installation details please refer to product installation manual

All graphics & pictures are for illustration only

FLOOR WARMING PRODUCTS



Copyright 2006-2012 © All rights reserved. www.decoragroup.com www.domotek.com & all related companies. The materials in this page, may not be reproduced, photocopied, displayed, modified or distributed in any form whatsoever without the express prior written permission of the copyright holder.





## BASIC FH CABLE

- Heating cable ideal for complicated layouts
- Optimal customization

- Domotek's Basic FH Cable is a heating system designed for in-slab installation suitable mainly for new construction.

- Can be installed in specific areas or throughout the entire house, for wet installation.

### TECHNICAL DATA:

FHC 2 B 4 –663 DOMOTECK

Output Cable	17W/m
Voltage	~230V
First Layer	XLPE
Outer Insulation	XLPE
Thickness of wire	~6.0mm
Protection class/means	I + 30mA RCD
Connection	One side - Twin conductor
Cable Color	Black
Supply Lead Length	4m

**RECOMMENDED FOR UNDER:** Tiles and natural stone although it can be installed under other floor coverings such as: parquet, laminate, linoleum or carpets, in these cases the mat must be integrated into a 35mm layer of self-leveling concrete.

- Domotek Basic FH Cable has a twin conductor (a one-point connection to the wiring system of the building).
- Different anchoring means are available.

All graphics & pictures are for illustration only

Floor Warming Products



Copyright 2006-2012 © All rights reserved. www.decoragroup.com www.domotek.com & all related companies. The materials in this page, may not be reproduced, photocopied, displayed, modified or distributed in any form whatsoever without the express prior written permission of the copyright holder.



# BASIC FH CABLE

## Technical Applications & Installation

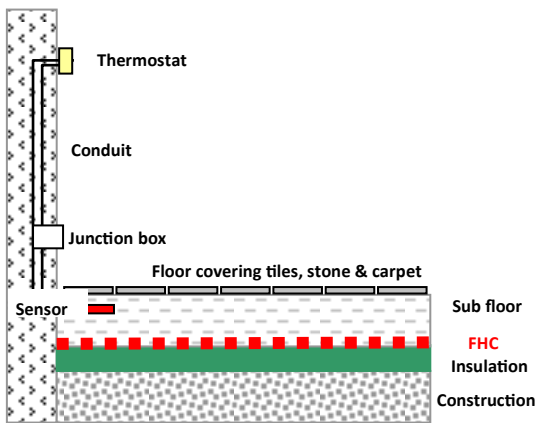
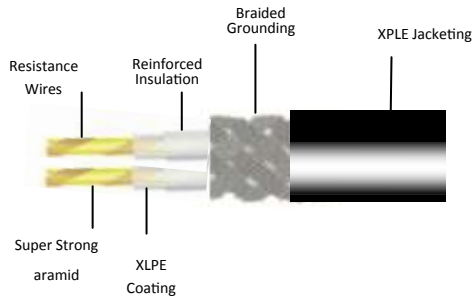

## Installation

- 1 Plan the layout
- 2 Fault Indicator
- 3 Place insulation boards
- 4 Fasten the spacers
- 5 Fix cable into the spacers
- 6 Pour the self leveling concrete
- 7 Test resistance
- 8 Set the thermostat

### DOMOTECK'S WARRANTY POLICY

Domotek's products are guaranteed by a 10-year Limited Product Warranty, and are designed to safely operate in accordance to the life-span of the application in which they are installed.

For full installation details please refer to product installation manual

All graphics & pictures are for illustration only

FLOOR WARMING PRODUCTS



Product	Name	Article No.	Application
	Tube for Sensor 12m 1.5m	9721 440 219	Installation of Thermostat Sensor
	90°C Angle AC 704 8-12	9721 440 218	Fixing Sensor Tube in place
	Installation Kit AC 718 Including pipe 14/2 + angle + corrugated 2.5m + electrical box	9725 470 095	Installation of control unit
	Plastic Nails AC 714	9721 440 136	Fixing mats into place
	Aluminum adhesive tape 50m	9721 440 199	For fixing cable to the sub floor
	Fixing Strip Aluminum Length 1m	9721 440 123	For Cables Spacing loops - 50mm
	ECC 3 (electrical connection chain)	9721 440 894	ECC-connection
	ECC 5 (electrical connection chain)	9721 440 895	ECC-connection



*domo*  
**teck** LTD.  

---

*low temperature heating*

**Contact Information:**

[info@domoteck.com](mailto:info@domoteck.com)

[www.domoteck.com](http://www.domoteck.com)